

# Battery Charger

## Advanced Fan Assisted Charger

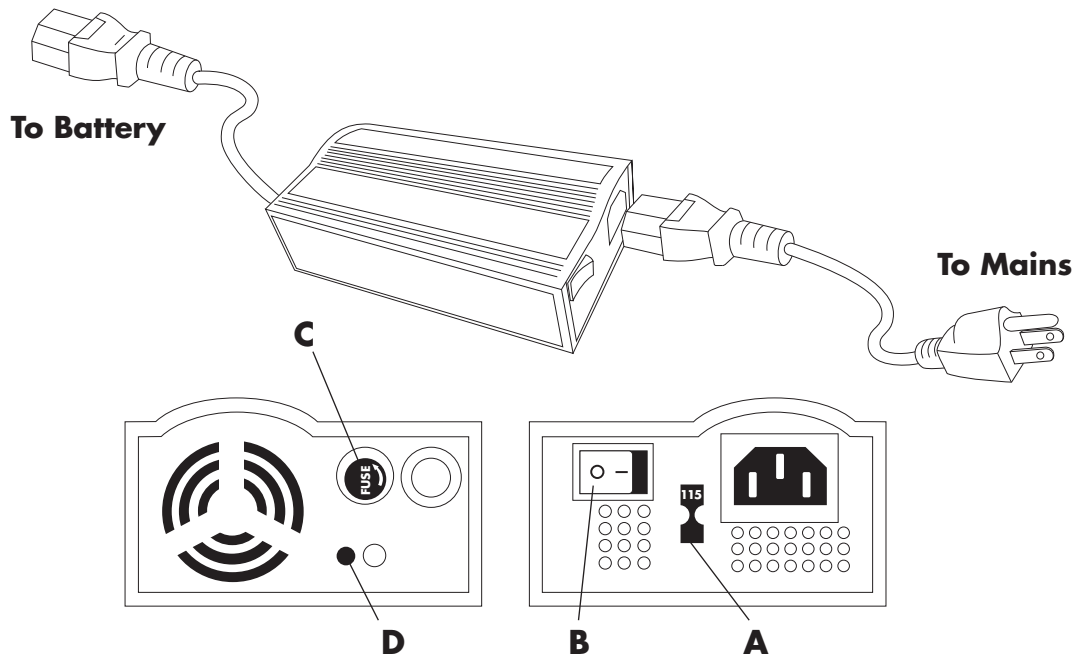

### 1) Specifications

Model No. HP8204A  
U/L listed  
CE Approved  
GEL Sealed Lead Acid (SLA) Charger  
Input: 115/230 Volts AC (Switchable) 60/50Hz 3/1.5Amps  
Output: 36 Volts DC 2Amps  
Fan Assisted  
Metal Housing  
Fuse 125V 10Amp (C)

### 2) Light Indications (D)

**Red** Power On  
**Yellow** Charging  
**Green** Fully Charged

### 3) Charger Operating Instructions

- Adjust the Voltage Switch (115V or 230V) to the correct setting. (UK = 230V) (A)
- Connect the charger to the Battery and then the Mains.
- Switch on power after connection to Battery (B)
- When finished charge, switch off charger before removing from Battery.

### 4) Important Information

- Charge only GEL and Sealed Lead Acid (SLA) rechargeable type batteries with this unit.
- Only use the specified rated Fuses.
- The charger will become warm during charging.
- Charge in well ventilated areas and do not cover or place items on the Charging Unit.
- Only operate in clean and dry atmospheres.
- Use only with the original intended battery.
- Misuse of Charger could result in fire or damage of the batteries.

**Although this advanced charger has auto-cut off it is not recommended to leave switched on for prolonged periods.**

**The Batteries should be charged after every journey to ensure longevity of life.**

**Batteries should not be left in an uncharged state for more than 1 week.**